

# Dolphin PRO/PRO2/PRO3 Installation Guide

---

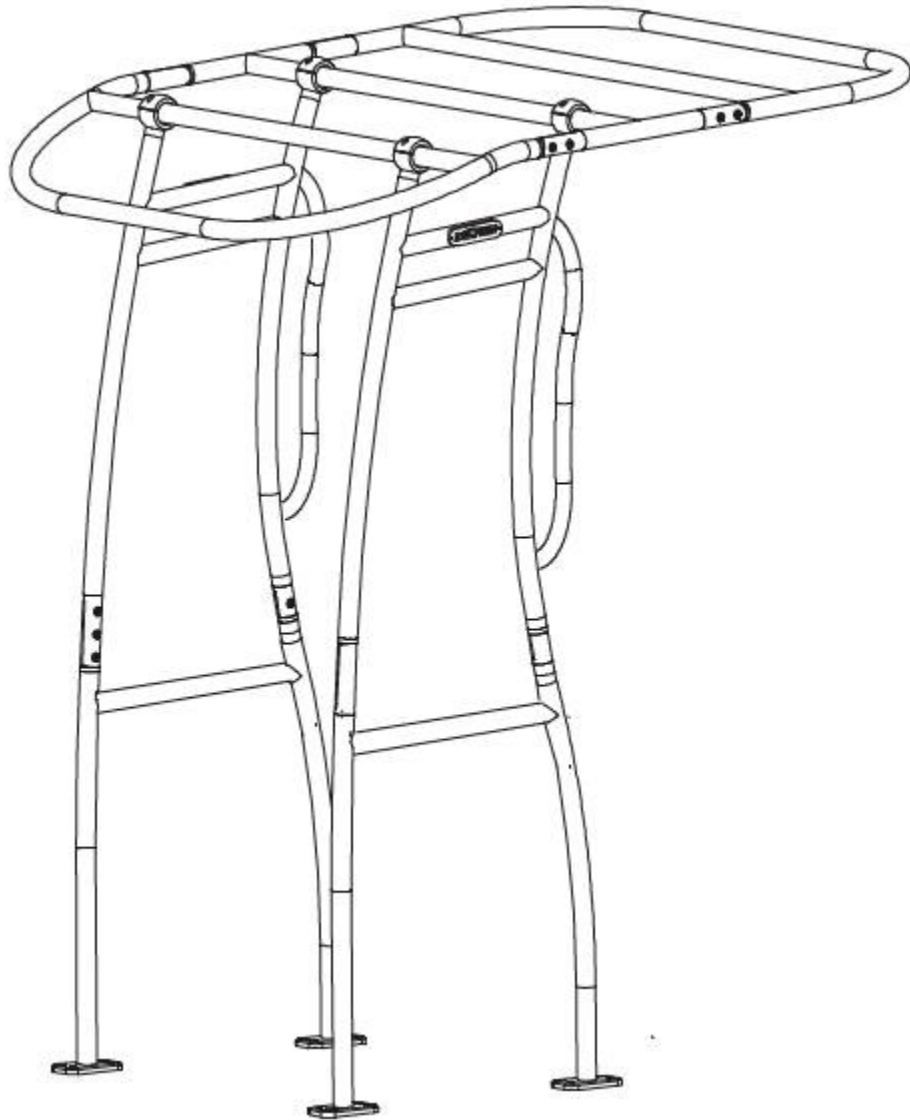

Structure of Dolphin Pro/Pro2 T Top

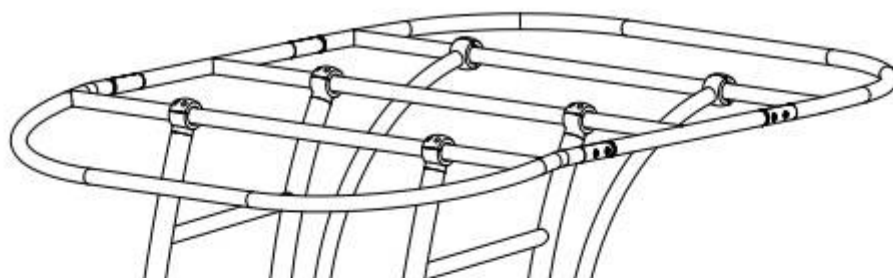

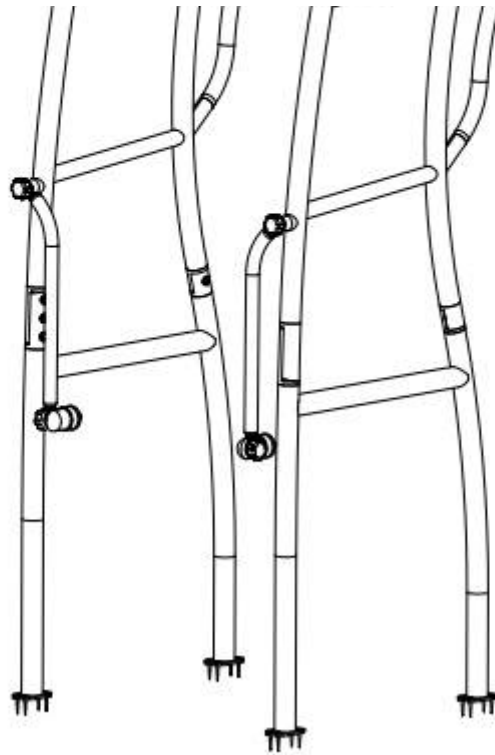

Structure of Dolphin Pro3 T Top

EXPLODED VIEW OF THE DOLPHIN PRO/PRO2 T TOP FOR REFERENCE

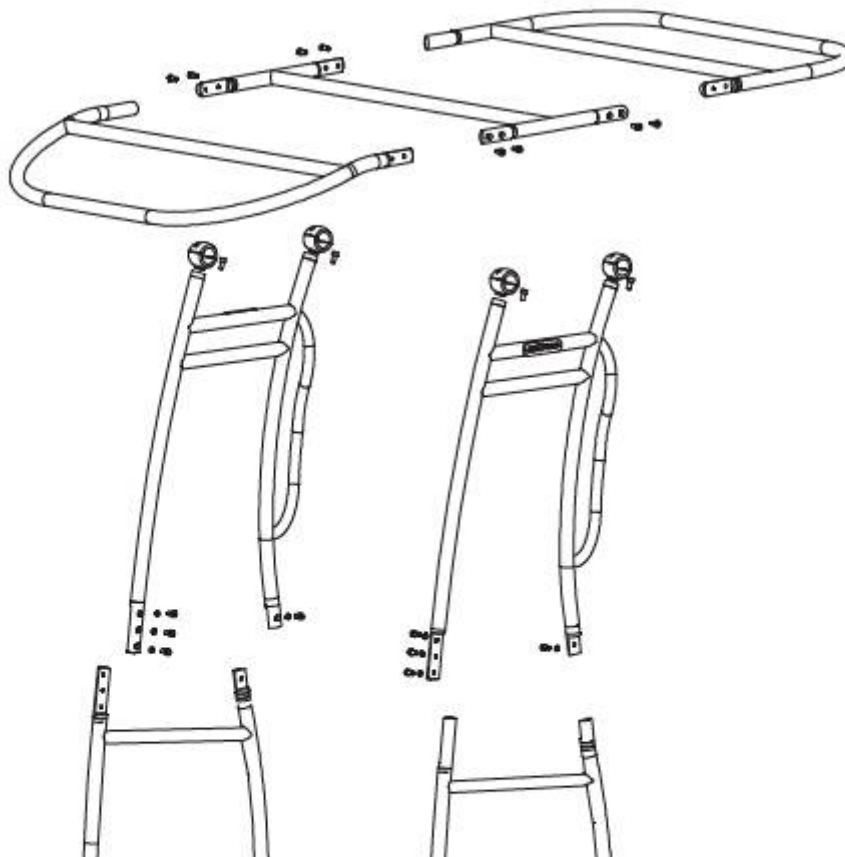



EXPLODED VIEW OF THE DOLPHIN PRO3 T TOP FOR REFERENCE

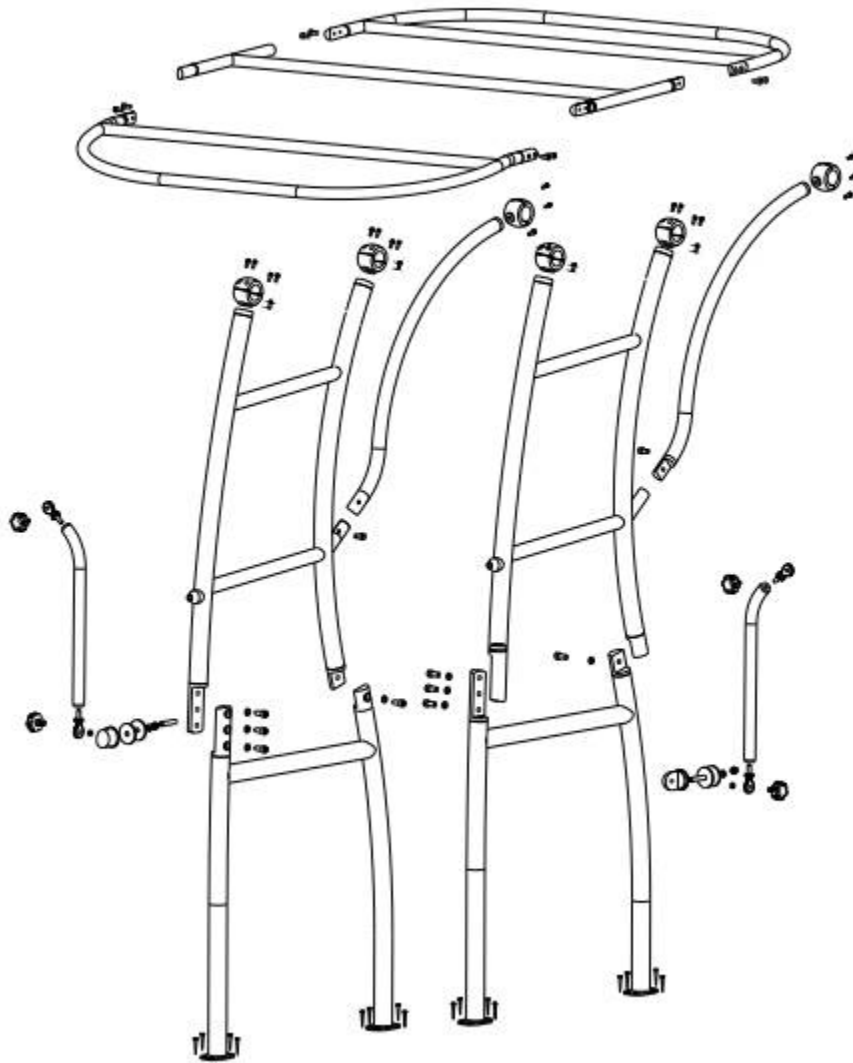

STEP 1:

Unpack and check the contents of the box and check parts list.

Please Read all Instrustion prior to installation

If you are NOT sure of any part of the guide or you have any questions

Please contact the supplier or DOLPHIN T Tops

PARTS LIST

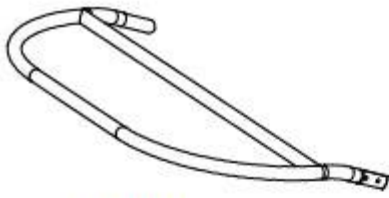

1 x Front

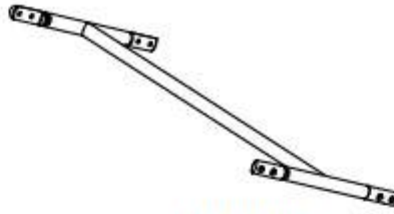

1 x Centre



1 x Rear

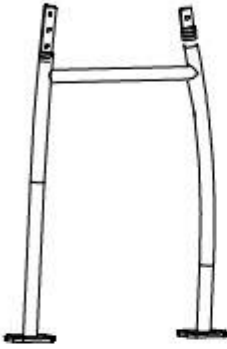

1 x base Stbd

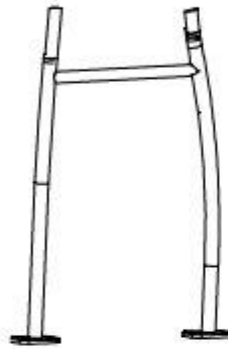

1 x base Port

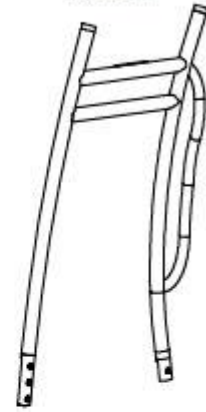

1 x Stbd

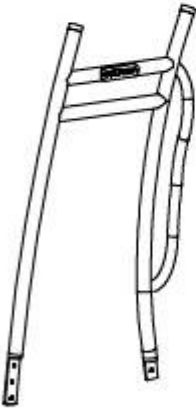

1 x Port

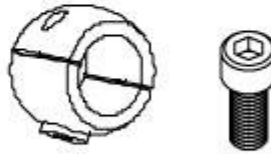

4 x Ball Clamps with  
4 x Rubber inserts  
4 x Allen head bolts



8 x M12 Bolts for Main  
Support frame



8 x M10 Bolts  
for top section frame

1 X CANVAS  
TOP COVER WITH ZIPPER

2 x Standoffs with bolts  
16 x long bolts and nuts  
& backing plates for deck  
mounts

STEP 2:

Positioning of the lower half of the side frame.

Distance from the centre console to lower side frame (1inch to 7inch) Check under the floor for wires or other objects that could effect the mounting Place the lower half of side frame in the desired postion and mark as a reference Remove the side frames and Measure the distance between the front mounting position from Port to Starboard (side to side) Right this measurement down

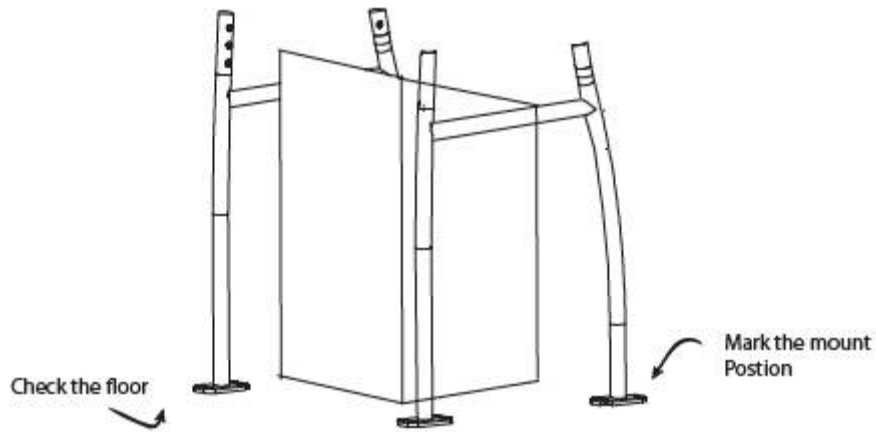

**STEP 3: Assemble the side support frame**

Attach the lower half and upper half of the side frames using the bolts and split washers. Note the Dolphin logo faces outwards from the boat. Note the bolt heads will be concealed in the counter sunk area and face inwards towards the console. Note you have a Port and Starboard Side Frame as described above logos facing outwards

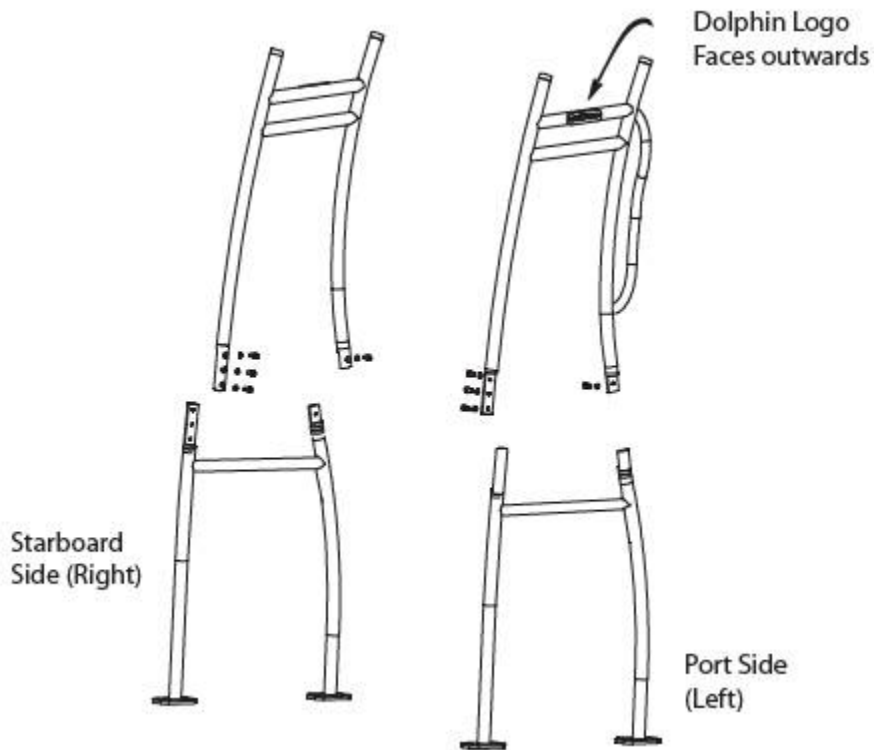

**STEP 4: Attach the ball clamps to top of Side Frames**

The top of the side frame has a counter sunk circle with a threaded hole, the ball clamps have a raised circle area. Insert the raised circle area into the counter sunk hole of the side frame insert bolt from inside the ball clamp into the side frame end and tighten. NOTE Allow the ball clamp to rotate very slightly for adjustment.

**NOTE:** For Pro3 t top, there is 2 smaller clamps which must be assembled onto the 3rd bow of the top frame for attaching the 2 large handles. But please don't attach the handles at this time. Keep the clamps movable until you install the legs and find the exact position where you can tighten it.

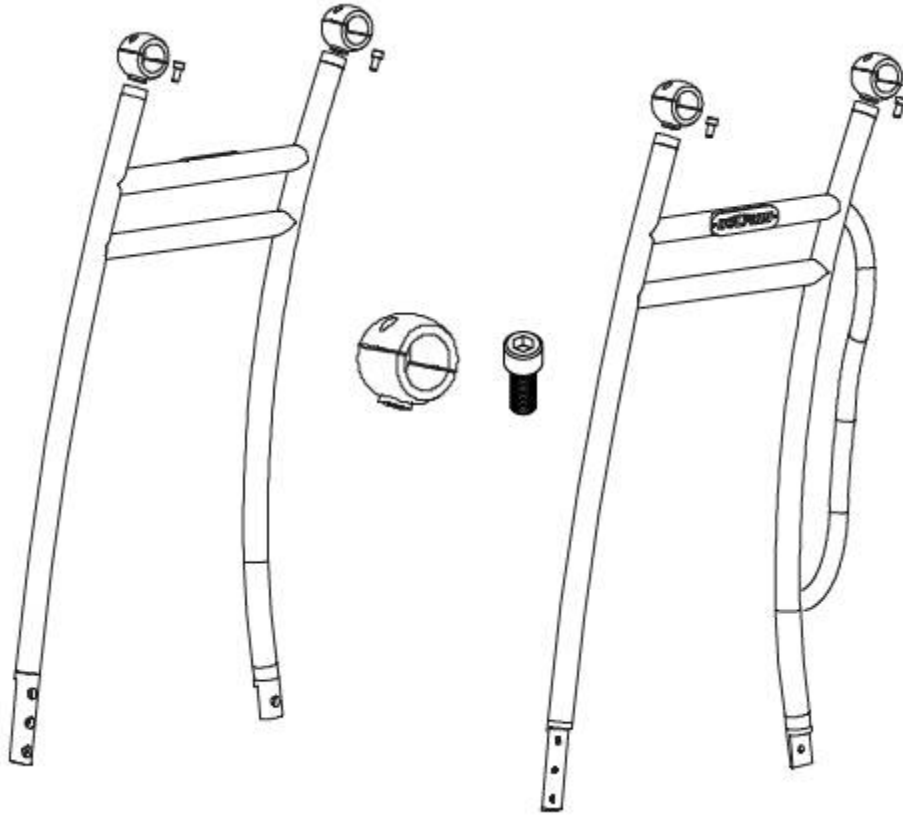

**STEP 5:** Assemble the front and centre section of the top frame

Note the shape of the front section is narrow and also has a bend curve which faces downwards when attached to the side support frames of the T Top.

Note the lap joints have a number on the flat face match these up for correct installation.

**DO NOT** use washer for top frame assembly, the washer is for support frame only!

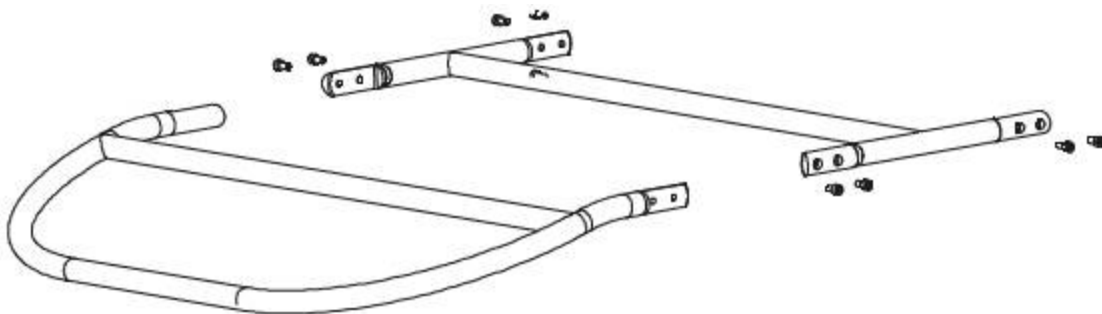

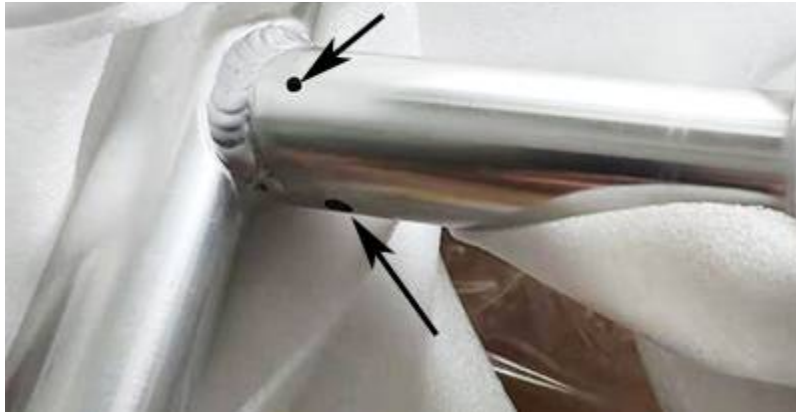

**IMPORTANT: These small holes should be at the same side of each bow otherwise it is not a correct installation and you may meet trouble when attach the top frame to the legs.**

#### STEP 6: Attach the Side Supports to the Assemble Top Section

Check the direction of the side support arms Logo to the outside, handle to the rear The small curved top frame for the cover curves and bends downwards to the floor

Remove the tops of the ball clamps please NOTE the clamps are to be placed on the same way (they are numbered inside)

Find the centre of the cross bar on the top section mark this. Use the measurement you marked out for the position of the deck mounts Mark this in the two cross beams on the top section that is assembled.

Attach the partial top section to the support frame ensuring all parts are facing the correct direction. (refer to pictures of T Tops for reference if unsure.)

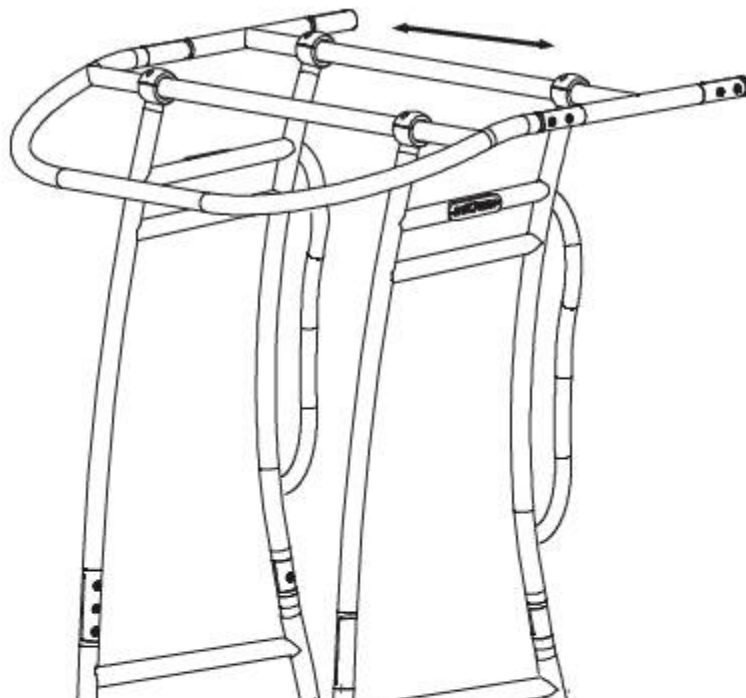

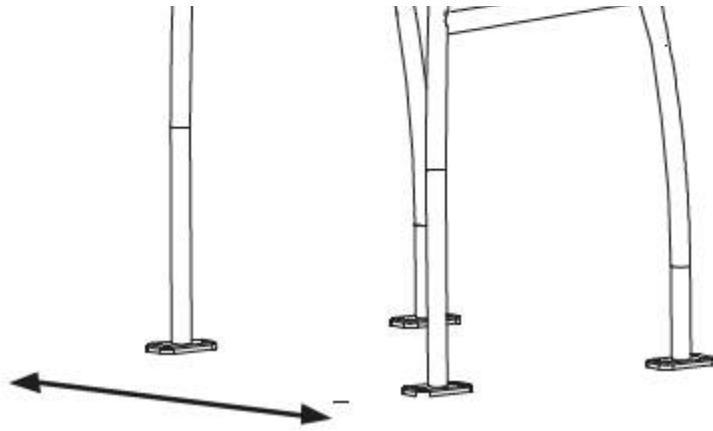

STEP 7: Attach the T top to the floor of the boat

Place the T Top you have assemble on the marks you have made near your console Now you can pre drill and use the bolts and backing plates and lock in you mounting points NOTE: Check under the floor for any wires or objects before drilling holes.

STEP 8: Attach rear section of the top frame to the T Top

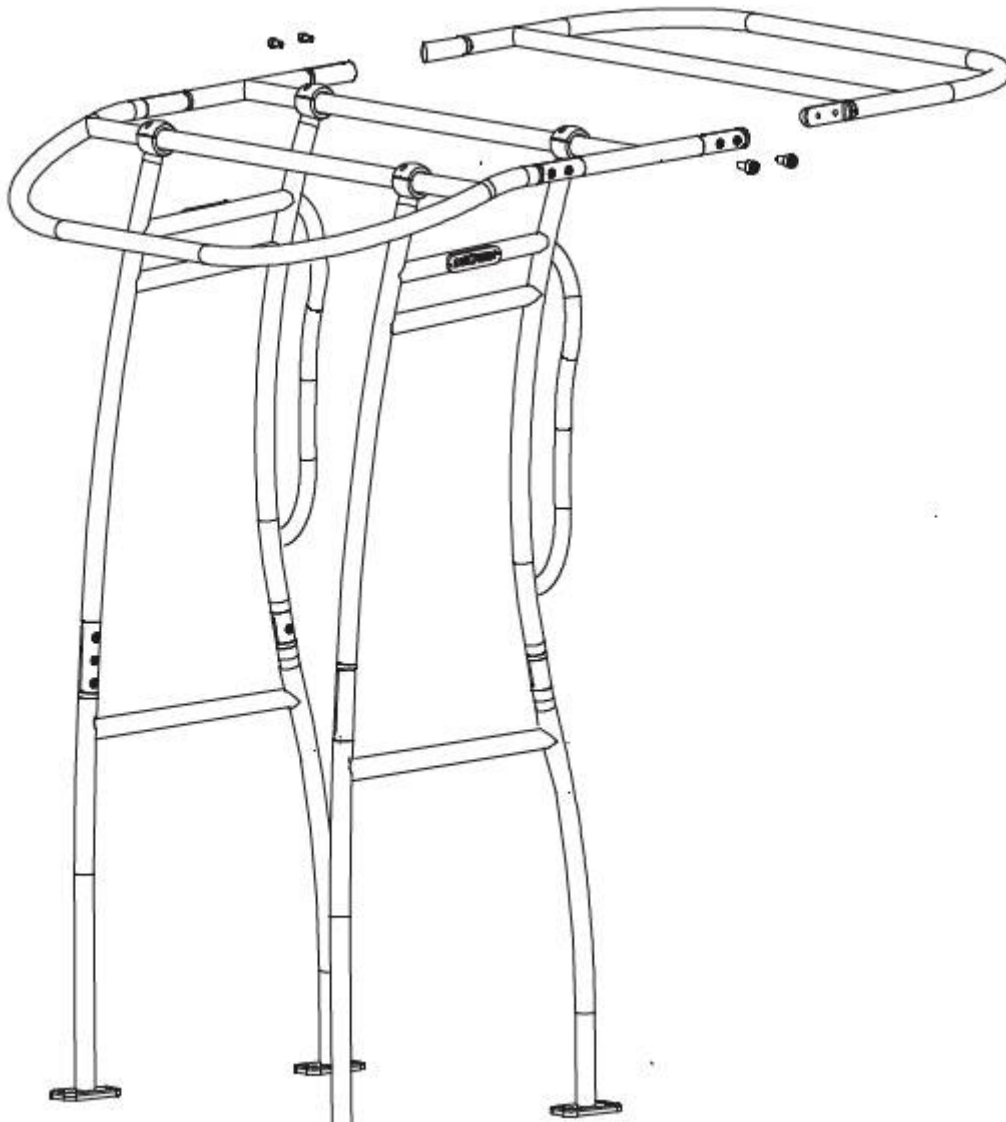





STEP 9: Attaching the cover to the top frame.

Remove the cover and lay out on the ground. Note: there is a zipped front pocket which is zippered from side to side. Place this over the front section of the T top and zipper up now you can fold out over the rest of the top frame and hook over the back and zipper this section up and the velcro corner sections. Now you can pull tight the side section with zippers and velcro tabs.

STEP 10: Attaching stands to T Top side main frames.

